

CQ Strawberry Basil Infused Iced Tea

1 pouch recipe will fill our 3.5-gallon beverage dispenser twice



1 Ingredients

- 1 Pouch of CQ Strawberry Puree
- 12 Stalks of Basil
- 3 Gallons Brewed Iced Tea (Chilled)

2 Decorating the Beverage Dispenser

To set the insert in place, position a slice at each corner of the jar between the insert and the jar. Use the CQ Slicer Key/Wand to push the slices all the way down. Decorate the rest of the jar using the CQ Slicer Key/Wand to position the remaining slices as shown in the picture.

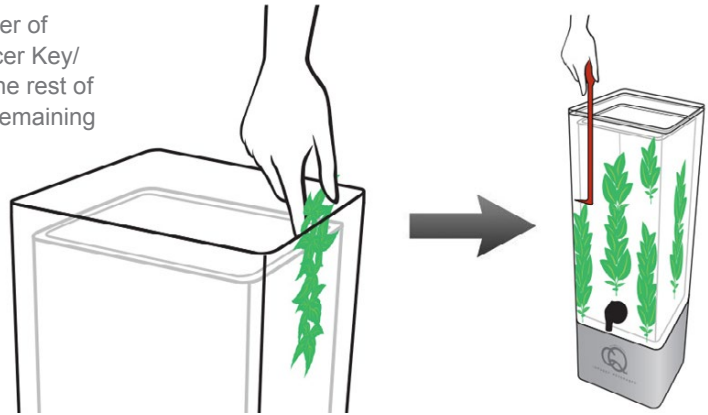

3 Infusing the Iced Tea

Using the CQ Slicer Key/Wand to measure, fill the CQ Mixing Bucket with 3 gallons of cold, filtered water. Add 1 pouch of CQ Puree and stir. Next, place a metal strainer in the mixing bucket and muddle any remaining slices. This technique will ensure that no pieces end up blocking the spigot later.

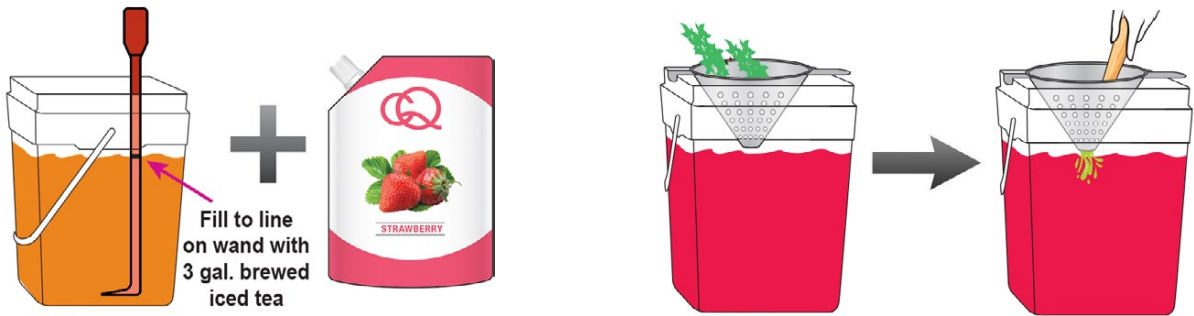

4 Filling, Serving & Refreshing

Fill the beverage container to the top with ice cubes (about 10 lbs.) and add the CQ Strawberry Basil Iced Tea. To refresh, add equal amounts of ice and CQ Infused Iced Tea.

